

## Sitomatic 110VAC Valve Controller

- € Direct I/O position indication module
- € For 110VAC systems
- € For manual Valves 0 to 90° and 0 to 180°
- € With 2 110VAC position feedbacks
- € Without Mechanical switches
- € Optional : LED Dome
- € Optional : Stainless Steel screw cover

**Valcotec** 

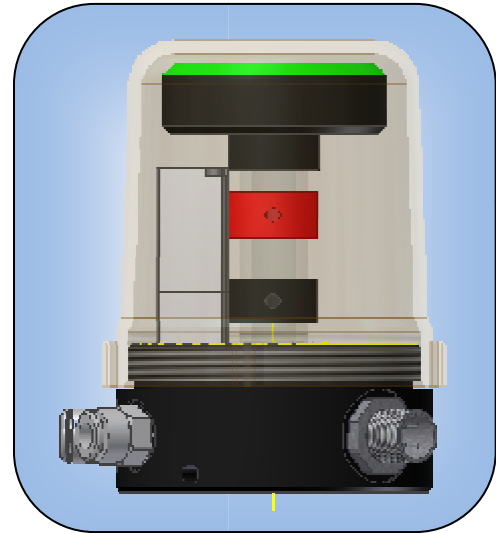

### Valcotec Valve-controller 110VAC

Type: SVPI 1002-14

Equipped with:

- POM Baseplate
- 2 Position initiators **open** (up) and **close** (down), output 110VAC 1Amp max
- With Dome LED's for the open and close position
- 5- pole M12x1 male screw connector
- Exclusive mounting kit
- with PC clear cover





### Valcotec Manual Rotary Valve-controller 110VAC

Type: SVPI 2502-02 (0-90°) -03 (0-180°)

Equipped with:

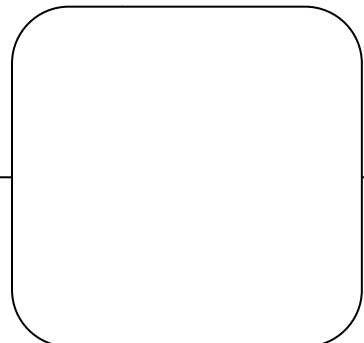
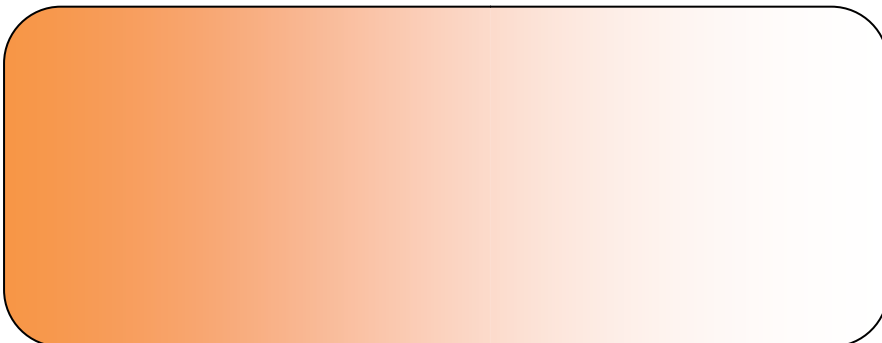
- POM Baseplate
- 2 Position initiators **open** (90° / 180°) and **close** (0°), output: 110VAC 1Amp max
- With Hyper LED Dome (Closed= Green, Open = Amber)
- 5- pole M12x1 male screw connector
- Exclusive mounting kit
- with PC clear cover



Technical Data	SVPI 1002-14	SVPI 2502-12 / 13	
 <b>Direct I/O 110VAC</b>			
<b>Material</b>			
<b>Body</b>	Pom (black)	Pom (black)	
<b>Cover</b>	POM cover with transparent cap	Polycarbonate, (transparent brown)	
<b>sealing</b>	NBR	NBR	
<b>Power Supply</b>	110VAC	110VAC	
<b>Electrical connection</b>			
<b>Multipole connection</b>	M12x1 (5-pole) connector	M12x1 (5-pole) connector	
<b>Sensor Input</b>	Internal	internal	
<b>Sensor output voltage</b>	110VAC	110VAC	
<b>Output current</b>	1 Amp	1 Amp	
<b>Type</b>	Hall	Hall	
<b>Feedback</b>			
<b>Pos. open (digital)</b>	Red	Integrated in Valve	
<b>Pos. Closed (digital)</b>	Black	Integrated in Valve	
<b>Stroke range Valve spindel</b>	3.....35 mm	0...90° / 0....180°	
<b>Solenoid valve type</b>	3/2-way NC	3/2-way NC	
<b>Power consumption [Vdc/W]</b>	110VAC / 0.5 Watt	110VAC / 0.5 Watt	
<b>Response time [ms]</b>	15	15	
<b>Seal-material</b>	NBR	NBR	
<b>Supply pressure</b>	7 Bar max	7 Bar max	
<b>Control medium</b>	Neutral gases, air DIN ISO 8573-1	Neutral gases, air DIN ISO 8573-1	
<b>Dust concentration</b>	Class 3 (<5µm particle size)	Class 3 (<5µm particle size)	
<b>Particle density</b>	Class 3 (<5mg/m³)	Class 3 (<5mg/m³)	
<b>Pressure condensation point</b>	Class 3 (<-20°C)	Class 3 (<-20°C)	
<b>Oil concentration</b>	Class 1 (< 0,01 mg/m³)	Class 1 (< 0,01 mg/m³)	
<b>Air input filter</b>	-Install air filters close to valve at their upstream side. A filtration degree of 5 µm or less should be selected		
<b>Install an air dryer, after cooler or Drain Catch, etc</b>	-Air that includes excessive drainage may cause malfunction of valves and other pneumatic equipment. To prevent this, install an air dryer, after-cooler or water separator,etc		
<b>If excessive carbon powder is seen, install a mist separator on the upstream side of the valve</b>	-If excessive carbon dust is generated by the compressor, it may adhere to the inside of valves and cause malfunction		
<b>Pilot air ports</b>	1/8"G / plug-on fitting 6.0	1/8"G / plug-on fitting 6.0	
<b>Ambient temperature</b>	-10.....+50°C ( no freezing.)	-10.....+50°C ( no freezing.)	
<b>ElectricalProtection class</b>	III	III	
<b>Housing protection class</b>	IP 67	IP 67	
<b>Installation</b>	As required, preferably with actuator in upright position	As required, preferably with actuator in upright position	
<b>General Conformity</b>	according to CE in compliance with EMC2004/108/EG	according to CE in compliance with EMC2004/108/EG	
<b>Display Valve-closed position</b>	LED Dome Green	LED Dome Green	
<b>Display Valve-open position</b>	LED Dome Amber	LED Dome Amber	
<b>DimensionsBxH</b>	70 x 116	70 x 116	